

**NOTICE!!**

**These documents have been scanned!**

**Do not place un-scanned documents beneath this notice!**

**Do not remove this notice from this file!**

GPO Jacket No. 560-102  
Print Order 61540  
Rise Business Services, LLC  
Job=AZ15 5/21/2019



Box Number= AZ15075



Claim Begin-End: AMC452752-AMC452752

**1 Initial Receipt**



AZ15075-33

AMC452444-AMC452831

**United States Department of the Interior**

**Bureau of Land Management**

DIV OF LANDS, MINRLS & ENERGY

ONE N CENTRAL AVE

PHOENIX, AZ 85004 -4427

Phone: 602-417-9200

Receipt

No:

4333695

<b>Transaction #:</b> 4450411	
<b>Date of Transaction:</b> 12/13/2018	
CUSTOMER:	
DEPARTMENT OF LAND TRANSFER INFORMATION INC 942 CALLE AMANECER STE B SAN CLEMENTE, CA 92673-6220 US	

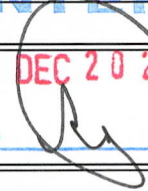
ENTERED  
DEC 20 2018  
BY: 

LINE #	QTY	DESCRIPTION	REMARKS	UNIT PRICE	TOTAL
1	1.00	LOCATABLE MINERALS / MINING CLAIMS-NEW, UNADJUD, ONE OR MORE AUTH NOS / NEW MINING CLAIM PROCESSING FEE <b>CASES: AMC452752/\$20.00</b>		- n/a -	20.00
2	1.00	LOCATABLE MINERALS / MINING CLAIMS-NEW, UNADJUD, ONE OR MORE AUTH NOS / NEW MINING CLAIMS LOCATION FEE <b>CASES: AMC452752/\$37.00</b>		- n/a -	37.00
3	1.00	LOCATABLE MINERALS / MINING CLAIMS-NEW, UNADJUD, ONE OR MORE AUTH NOS / NEW MINING CLAIMS MAINTENANCE FEE <b>CASES: AMC452752/\$155.00</b>		- n/a -	155.00
<b>TOTAL:</b>					<b>\$212.00</b>

PAYMENT INFORMATION			
1	AMOUNT:	212.00	POSTMARKED: N/A
	TYPE:	CHECK	RECEIVED: 12/12/2018
	CHECK NO:	10094	
	NAME:	DEPARTMENT OF LAND TRANSFER INFORMATION INC 942 CALLE AMANECER BLDG A SAN CLEMENTE CA 92673-6220 US	

REMARKS

This receipt was generated by the automated BLM Collections and Billing System and is a paper representation of a portion of the official electronic record contained therein.

**NOTICE!!**

**These documents have been scanned!**

**Do not place un-scanned documents beneath this notice!**

**Do not remove this notice from this file!**

GPO Jacket No. 560-102  
Print Order 61540  
Rise Business Services, LLC  
Job=AZ15 5/21/2019



Box Number= AZ15075



Claim Begin-End: AMC452752-AMC452752

**2 Correspondence**



AZ15075-33

AMC452444-AMC452831

**NO  
DOCUMENTS  
FOUND**

NO DOCUMENTS FOUND  
NO DOCUMENTS FOUND

**NOTICE!!**

**These documents have been scanned!**

**Do not place un-scanned documents beneath this notice!**

**Do not remove this notice from this file!**

GPO Jacket No. 560-102  
Print Order 61540  
Rise Business Services, LLC  
Job=AZ15 5/21/2019



Box Number= AZ15075



Claim Begin-End: AMC452752-AMC452752

**3 Transfers**



AZ15075-33

AMC452444-AMC452831

**NO  
DOCUMENTS  
FOUND**

NO DOCUMENTS FOUND  
NO DOCUMENTS FOUND

**NOTICE!!**

**These documents have been scanned!**

**Do not place un-scanned documents beneath this notice!**

**Do not remove this notice from this file!**

GPO Jacket No. 560-102  
Print Order 61540  
Rise Business Services, LLC  
Job=AZ15 5/21/2019



Box Number= AZ15075



Claim Begin-End: AMC452752-AMC452752

**4 Annual Filings**



AZ15075-33

AMC452444-AMC452831

Amc 452752

UNITED STATES  
DEPARTMENT OF THE INTERIOR  
BUREAU OF LAND MANAGEMENT

**CREDIT CARD PAYMENT**  
**For Mining Claim Maintenance Fee**

THIS IS A CHANGE OF ADDRESS <sup>VAD</sup>

TELEPHONE SUBMISSION - ACCURACY OF THE BELOW INFORMATION IS THE RESPONSIBILITY OF THE CLAIMANT/OWNER

NAME RUSSELL ANDERSON  
ADDRESS 610 JACK BURDEN ROAD LOT 23  
CITY WICKENB STATE AZ ZIP 85390  
PHONE # 541 - 954-8492

SEND RECEIPT TO  Above address  
 Other (Include Name and Mailing Address):  
\_\_\_\_\_  
\_\_\_\_\_  
\_\_\_\_\_

AMC NUMBER 458327<sup>AD</sup> CLAIM/SITE NAME BLUE BELL MINE  
452752

1 # of Claim/Site  
x 165.00 Each  
\$ 165.00 Total Charged EG (INITIALS)  
RECEIPT # 4522858

DATE STAMP

RECEIVED  
STATE OFFICE  
2019 AUG -2 A 9:59  
PHOENIX, ARIZONA

\*\*\*\*\* FOR OFFICIAL USE ONLY \*\*\*\*\*  
DATE \_\_\_\_\_ INITIALS \_\_\_\_\_ VERIFIED \_\_\_\_\_

Entered 8/19/19 AD



**United States Department of the Interior**  
**Bureau of Land Management**  
 DIV OF LANDS, MINRLS & ENERGY  
 ONE N CENTRAL AVE  
 PHOENIX, AZ 85004 -4427  
 Phone: 602-417-9200

Receipt

No: 4522858

<b>Transaction #:</b> 4643539	
<b>Date of Transaction:</b> 08/02/2019	
CUSTOMER:	
RUSSELL ANDERSON 610 JACK BURDEN RD LOT 23 WICKENBURG, AZ 85390-1545 US	

LINE #	QTY	DESCRIPTION	REMARKS	UNIT PRICE	TOTAL
1	1.00	LOCATABLE MINERALS / MINING CLAIMS- NOT NEW-UNADJUD, ONE AUTH NO. ONLY / MINING CLAIM MONEY RECEIVED <b>CASES: AMC458327/\$165.00</b>	2020 MAINT (1)	- n/a -	165.00
<i>AMC 452752</i>				<b>TOTAL:</b>	<b>\$165.00</b>

PAYMENT INFORMATION			
NOTE: Items will appear on credit card statement as "Bureau of Land Mgmt CO".			
1	AMOUNT:	165.00	POSTMARKED: N/A
	TYPE:	CREDIT CARD	RECEIVED: 08/02/2019
	NAME:	ANDERSON, RUSSELL 610 JACK BURDEN RD LOT 23 WICKENBURG AZ 85390-1545 US	
	CARD NO:	XXXXXXXXXXXX9087	AUTH CODE: 009145
	NAME ON CARD:	RUSSELL A ANDERSON	
	SIGNATURE:	OVER THE PHONE	

REMARKS

This receipt was generated by the automated BLM Collections and Billing System and is a paper representation of a portion of the official electronic record contained therein.

**NOTICE!!**

**These documents have been scanned!**

**Do not place un-scanned documents beneath this notice!**

**Do not remove this notice from this file!**

GPO Jacket No. 560-102  
Print Order 61540  
Rise Business Services, LLC  
Job=AZ15 5/21/2019



Box Number= AZ15075



Claim Begin-End: AMC452752-AMC452752

**5 Miscellaneous**



AZ15075-33

AMC452444-AMC452831

**NO  
DOCUMENTS  
FOUND**

NO DOCUMENTS FOUND  
NO DOCUMENTS FOUND

**NOTICE!!**

**These documents have been scanned!**

**Do not place un-scanned documents beneath this notice!**

**Do not remove this notice from this file!**

GPO Jacket No. 560-102  
Print Order 61540  
Rise Business Services, LLC  
Job=AZ15 5/21/2019



Box Number= AZ15075



Claim Begin-End: AMC452752-AMC452752

**6 Location Notices-Amendments and Supporting Documents**



AZ15075-33

AMC452444-AMC452831

**MINING CLAIM STATUS REPORT**

Data Entered: 12/20/11

MTP Checked By: \_\_\_\_\_

GEO Checked By: \_\_\_\_\_

LEAD SERIAL NUMBER: AMC 452752 thru AMC \_\_\_\_\_

**NUMBER OF CLAIMS & TYPE:**

1 LODE  
\_\_\_\_ PLACER  
\_\_\_\_ ASSOCIATION PLACER  
\_\_\_\_ MILL SITE  
\_\_\_\_ TUNNEL SITE

**CHARGES:**

Processing Fee @ \$20 = \$ 20  
Location Fee @ \$37 = \$ 37  
Maintenance Fee @ \$155 = \$ 155  
Add'l Maint Fee for Assoc Placer = \$ \_\_\_\_\_  
**SUBTOTAL** \$ \_\_\_\_\_  
Other Fees \$ \_\_\_\_\_  
Other Fees \$ \_\_\_\_\_  
**TOTAL** \$ 212

TOTAL ACREAGE: \_\_\_\_\_ Per Claim  
(Placer Only)

NUMBER OF LOCATORS: \_\_\_\_\_

DOCUMENTS RECEIVED VIA : Over-the-Counter [ ] Mail [ X ] TIMELY FILED: Yes [ X ] No [ ]

LEGAL DESCRIPTION: T 6W R 5W SEC 6  
T \_\_\_\_\_ R \_\_\_\_\_ SEC \_\_\_\_\_  
T \_\_\_\_\_ R \_\_\_\_\_ SEC \_\_\_\_\_  
T \_\_\_\_\_ R \_\_\_\_\_ SEC \_\_\_\_\_  
T \_\_\_\_\_ R \_\_\_\_\_ SEC \_\_\_\_\_

BLM [ ] FOREST SERVICE [ ] SUBJ TO PL 359: Yes [ ] No [ ]  
WILDERNESS AREA [ ]

SPLIT ESTATE: N/A [ ] SX [ ] PX [ ] OTHER [ ]  
SRHA [ ] Was proper Notice filed if located on SHRA Land? Yes [ ] No [ ]

**RECONVEYED MINERALS ON BLM LAND REQUIRE OPENING ORDER FROM 1944 TO 1993:**

Open to Entry On \_\_\_\_\_ N/A [ ]

COMMENTS/STATUS: VOID [ ] PARTIALLY VOID [ ] PVT MINERALS [ ] WITHDRAWN LANDS [ ]  
OTHER [ ]

AMC452752

[ ] Claimant acknowledges that portions of the following claim(s) site(s) may be void or voidable.

Printed Name of Claimant \_\_\_\_\_ Signature of Claimant \_\_\_\_\_

\*\*\*\*\*FINAL ADJUDICATION\*\*\*\*\*

DATE \_\_\_\_\_ INITIALS \_\_\_\_\_

RECORDING REQUESTED BY:

(Mail recording to;)

Department of Land  
Transfer Information, Inc.  
942 Calle Amanecer, Suite B  
San Clemente, CA 92673

FOR RECORDER'S USE

**LOCATION NOTICE FOR LODE MINING CLAIM**

NOTICE IS HEREBY GIVEN that the **BLUE BELL MINE** lode mining claim has been located by Department of Land Transfer Information, Inc., a Wyoming Corporation whose current mailing address is 942 Calle Amanecer, Suite B, San Clemente, CA 92673.

The general course of this claim is East and West and it is situated in the Southeast and Southwest Quarters of Section 6, Township 6N, Range 5W, Gila-Salt River Meridian, Maricopa County, Arizona.

This claim is 1,500 feet in length and 600 feet in width. This claim runs from the location monument on which this location notice is posted approximately 1,200 feet in an Easterly direction to the East end line and approximately 300 feet in a Southerly direction to the South end line.

This claim is marked by four (4) monuments, one at each corner of the claim. Additionally, there are two (2) end-line markers on each side of the center of the claim. All markers are 4" x 4" wooden posts that are buried 1.5' in the ground and protrude 4.5' above the ground embossed with the name of the claim and its location in relation to the claim.

The location monument on which this notice is posted is situated within Section 6, Township 6N, Range 5W, Gila-Salt River Meridian, Maricopa County, Arizona and this claim encompasses portions of the following quarter section (s), Township (s) and Range (s); NW 1/4 of SE 1/4 and NE 1/4 of SW 1/4 of Section 6, T6N, R5W, Gila-Salt River Meridian, Maricopa County Arizona.

The locality of this claim with reference to some natural object or permanent monument and additional information (if any) concerning its locality are as follows: NE corner of this claim is 2,940 Feet South and 1,315 Feet West of the NE corner of Section 6, T6N, R5W.

DATED AND POSTED on the ground this 4th day of December, 2018.

Locator of this lode mining claim is:

**DEPARTMENT OF LAND TRANSFER INFORMATION, INC.**

  
\_\_\_\_\_  
Steven L. Cyros, President  
Authorized Officer for DEPARTMENT OF LAND TRANSFER INFORMATION, INC.

RECEIVED  
BLM AZ STATE OFFICE  
2018 DEC 12 P 2:48  
PHOENIX, ARIZONA

AMC452752

TOWNSHIP 6 NORTH RANGE 5 WEST OF THE GILA AND SALT RIVER MERIDIAN, ARIZONA

T 7N  
R 6W R 5W

MARICOPA COUNTY  
NASSAYAMPA FIELD OFFICE

STATUS OF PUBLIC DOMAIN  
LAND AND MINERAL TITLES

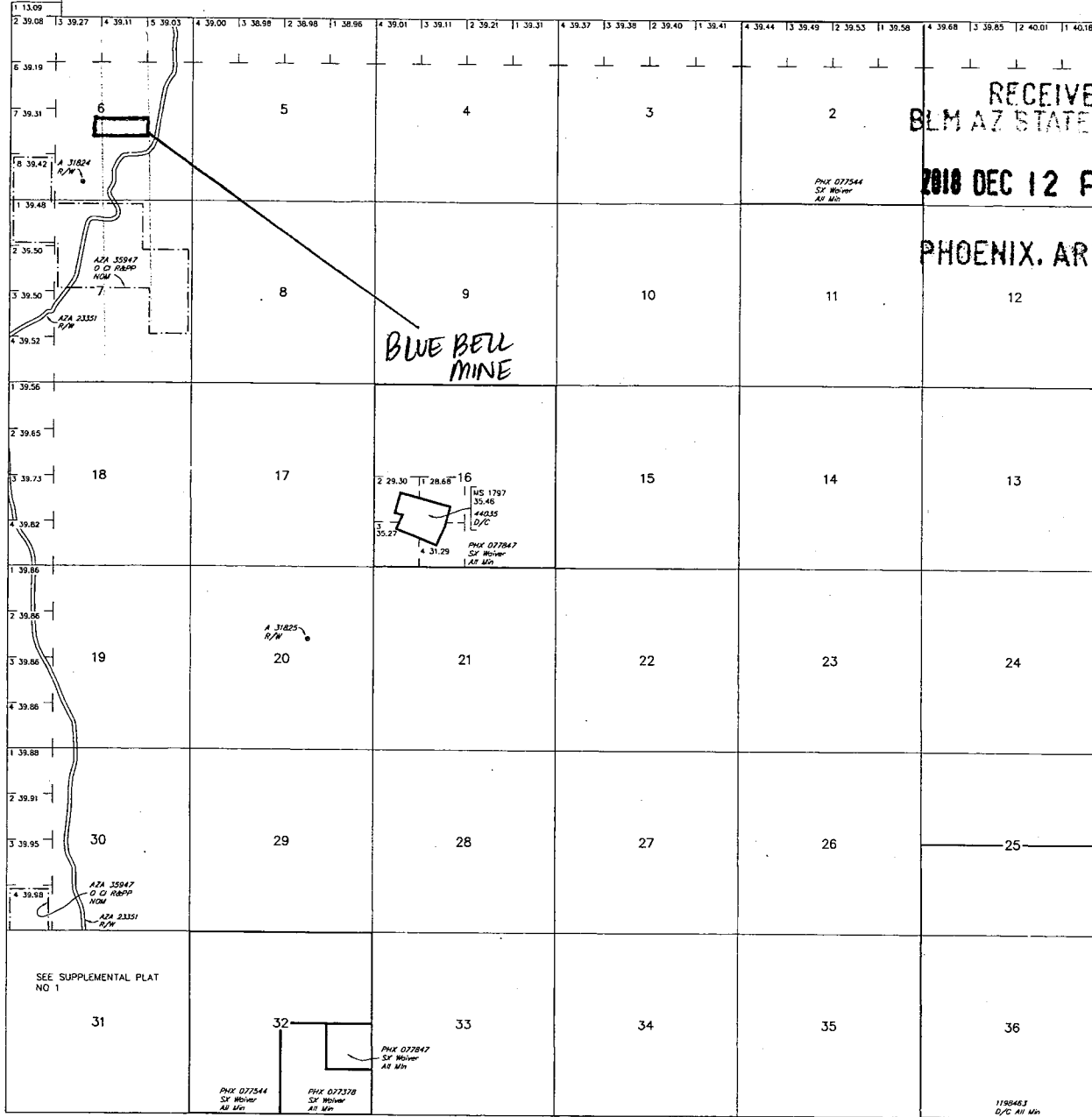

RECEIVED  
BLM AZ STATE OFFICE  
2018 DEC 12 P 2:48  
PHOENIX, ARIZONA

INDEX TO SEGREGATED TRACTS				
RESURVEY TRACT NO	ORIGINAL SURVEY			
	T	R	SEC	SUBDIVISION

FOR ORDERS AFFECTING DISPOSAL OR USE OF UNIDENTIFIED LANDS WITHDRAWN FOR CLASSIFICATION, MINERALS, WATER AND/OR OTHER PUBLIC PURPOSES, REFER TO INDEX OF MISCELLANEOUS DOCUMENTS.

MDS 295 NE  
297 SW  
299 SE

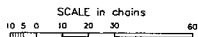

WARNING STATEMENT  
This plat is the Bureau's Record of Title, and should be used only as a graphic display of the township survey data. Recorders herein do not reflect title changes which may have been effected by lateral movements of rivers or other bodies of water. Refer to the cadastral surveys for official survey information.

Lot Long 33°48'35"N  
112°43'28"W

CURRENT TO	LT	GSR Mer
11-9-2015	ACAD	T 6 N R 5 W

AMC452752



# DEPARTMENT OF LAND TRANSFER INFORMATION

PROTECTING AMERICA'S RESOURCES

TEL 949.361.6618  
FAX 949.366.9945

WWW.LANDTRANSFER.US.COM  
942 CALLE AMANECER SUITE A  
SAN CLEMENTE, CA 92673

December 5, 18

Bureau of Land Management  
Arizona State Office  
One Central Avenue  
Suite 800  
Phoenix, AZ 85004-4427

RECEIVED  
BLM AZ STATE OFFICE  
2018 DEC 12 P 2:48  
PHOENIX, ARIZONA

RE: One (1) New Location Notice/Unpatented Mining Claim

To Whom It May Concern:

Enclosed, please find a check payable to Department of the Interior/BLM for payment in the amount of **\$212.00** for ONE new location notice for unpatented mining claim.

Should you need any additional information, please do not hesitate to call on me.

Warmest Regards,

Recording Department  
949.361.6618





# LR2000 Internal

## CR Geographic Report with Land

[Download User Guide \(pdf\)](#)

**Purpose:** This report produces a geographic listing of case information based on retrieval by Meridian/Township/Range. This report format will display the case type, case disposition, meridian, township, range, section, survey type, survey number, surface management agency, pending actions, serial number, and total case acres.

To refresh the query, do a **Ctrl-R**. It resets the page and clears any criteria fields that may have entries.



### No Results

The specified criteria didn't result in any data. This is often caused by applying filters and/or selection steps that are too restrictive or that contain incorrect values. Please check your analysis filters and selection steps, and try again. The filters or selection steps currently being applied are shown below.

#### Filters

Disposition is equal to **AUTHORIZED, CANCELLED, EXPIRED, PENDING, REJECTED, RELINQUISHED, WITHDRAWN**  
and Meridian Township Range Section is equal to **14 0060N 0050W 006 SW**  
and Admin State is equal to **AZ**

[Return - Refresh](#)



# LR2000 Internal

## CR Geographic Report with Land

[Download User Guide \(pdf\)](#)

**Purpose:** This report produces a geographic listing of case information based on retrieval by Meridian/Township/Range. This report format will display the case type, case disposition, meridian, township, range, section, survey type, survey number, surface management agency, pending actions, serial number, and total case acres.

To refresh the query, do a **Ctrl-R**. It resets the page and clears any criteria fields that may have entries.



### No Results

The specified criteria didn't result in any data. This is often caused by applying filters and/or selection steps that are too restrictive or that contain incorrect values. Please check your analysis filters and selection steps, and try again. The filters or selection steps currently being applied are shown below.

#### Filters

Disposition is equal to **AUTHORIZED, CANCELLED, EXPIRED, PENDING, REJECTED, RELINQUISHED, WITHDRAWN**  
and Meridian Township Range Section is equal to **14 0060N 0050W 006 SE**  
and Admin State is equal to **AZ**

[Return - Refresh](#)







This envelope is made from post-consumer waste. Please recycle - again.

# PRIORITY MAIL

DATE OF DELIVERY SPECIFIED \*

USPS TRACKING™ INCLUDED \*

INSURANCE INCLUDED \*

PICKUP AVAILABLE

\* Domestic only

RECEIVED  
BLM AZ STATE OFFICE  
DEC 12 P 2:58  
PHOENIX, ARIZONA

WHEN USED INTERNATIONALLY,  
A CUSTOMS DECLARATION  
LABEL MAY BE REQUIRED.



PS0000100CJ14

P14F July 2013  
OD: 12.5 x 9.5

UNITED STATES POSTAL SERVICE®

www.paypal.com

# P

US POSTAGE PAID  
Pitney Bowes  
ComBasPrice  
Flat Rate Envelope  
024P0007627129



## PRIORITY MAIL 2-DAY™

Department of Land Transfer Information,  
942 Calle Amanecer, Suite A  
San Clemente CA 92673

Delivery Date: 12/12/2018

0006

C041

AZ BLM State Office  
1 N Central Ave Ste 800  
Phoenix AZ 85004-4427

USPS TRACKING #



9405 8096 9993 9533 3016 23

VISIT US AT **USPS.COM**®  
ORDER FREE SUPPLIES ONLINE



# PRIORITY<sup>®</sup>

## ★ MAIL ★



**FLAT RATE ENVELOPE**  
ONE RATE ★ ANY WEIGHT\*



PS00001000014

EP14F July 2013  
OD: 12.5 x 9.5



\* Domestic only. \* For International shipments, the maximum weight is 4 lbs.